

# ◀◀◀ Laboratory Syringe Pump

## Programmable Syringe Pump



### Model Number

SPC/ZU-I

### Features

- | Two working mode: Independent working mode, each unit working independently, can infuse or withdraw with different speed in same time or different time. Logic working mode, each unit working with time relationship, with different proportion infuse or withdraw. Users can choose each unit to be independent or logic working mode.
- | Intelligent calibration, ensure infuse volume accuracy. Online micro adjusting function, convenient to adjust the volume of one units, decrease volume error.
- | Real time monitor, animate diaply monitor result. Controller can receive traffic alarm of each unit.
- | Back distance setting, can exclude bubbles inside syringe, improve volume accuracy.
- | Fast forward and backward function used for loading syringe, washing and unlock traffic protection.

### Introduction

7 inch touch screen control, display 8 pump units working parameters and working state. Friendly interface, easy operation. Split type design, mainly for laboratory.

### Dimension Drawing (Unit: mm)

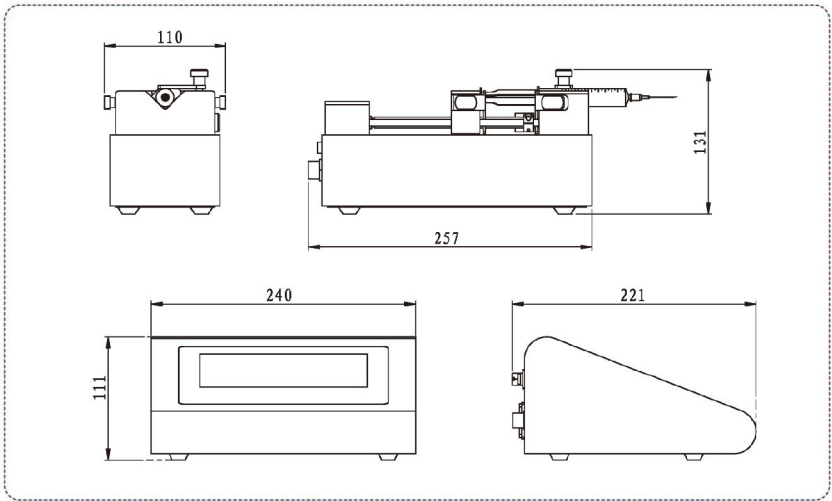

### Interface Display



### Technical Specifications

Working mode(Five)	Infusion,withdrawal,infusion/withdrawal,withdrawal/infusion	Stored modes	5 group data of each running mode
Pump unit	1-8 for option	Display	Industrial grade 7"LCD color display
Syringe size	10μL-60mL	Control method	Touch screen
Syringe selection	Available of the mainly manufacturer,type and syringe from, also can define syringe ID in same time	Power-off memory	Display the previous data parameter after power supply again
Linear speed range	1μm/min-132mm/min (Flow rate=Linear speed* syringe inner cut area)	External control signal	Start/stop signal,active switch signal: 5V, 12V, and 24V
Min. linear rate	1μm/min	Communication interface	RS232/RS485, Modbus protocol(RTU mode)
Linear force	≥16Kgf	Controller power supply	AC100-240V/15W
Max. stroke	90mm	Pump unit power supply	DC24V/24W
Stoke resolution	0.078μm/μStep	Condition temperature	0-40°C
Accuracy	Stroke≥30% maximum stroke, Error≤ ±0.5%	Relative humidity	<80%
Back distance	0.01--5mm	IP rate	IP31
Working mode	Independent running mode and Logic running mode	Controller dimension	240×221×111 (mm)
		Controller weight	2.1kg
		Pump unit dimension	257×110×131 (mm)
		Pump unit weight	2.6kg